

PLASTIC CHAIN AND SPROCKET

*(NON-STOCK ITEM, 60DAYS
TO 90 DAYS DELIVERY)*

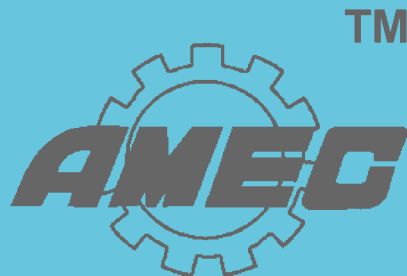

PLASTIC CHAIN AND SPROCKET

Straight Running Chain & Sprocket	D.1 TO D.4
Sideflex Chain and Sprocket	D.5 TO D.6
Snap-on Sideflexing Chain	D.7
Straight Running Anti-static Chain	D.8
Sideflexing Anti-static Chain	D.9
Belt Chain And-sprocket	D.10 TO D.14
Pivot Radius Chain with Tabs	D.15
Plastic Wearstrips	D.16
Accessories	D.17 TO D.20
Track Curve	D.21



PLASTIC CHAIN AND SPROCKET

Straight Running Chain & Sprocket (IN STOCK)

40P Plastic straight running chain

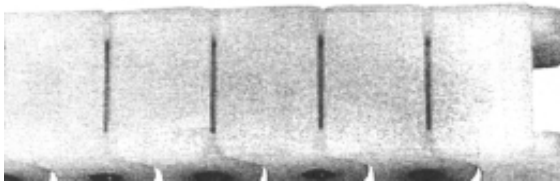

Chain Part NO.	Widths	
	Inch	mm
POM W (Acetal white)		
40P	0.79	20.00

Dimensions

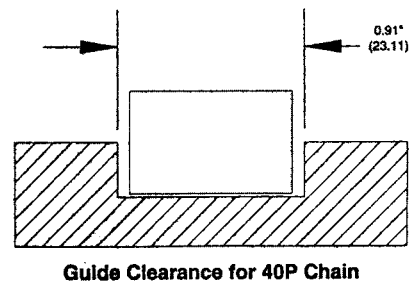
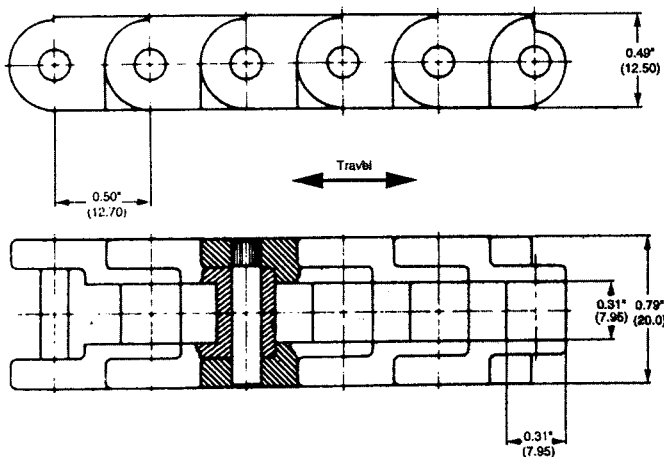

Technical Specifications

Tensile strengths @ 68°F (20°C)
 Acetal: W 100 lbf (445 N)
 Load capacity for use in RAM standard selection calculations

Backflex radius
 7.9" (200 mm)

Standard packing
 Approximately 10 feet (3 m)

- Available in Acetal (white).
- Standard pin material - 18/8 CrNi stainless steel.

- Can run at speeds up to 200 ft/min (1.0 m/sec).

- Driven by standard #40 roller chain sprockets.

Chain weights	
40P	
Weight lbs/ft	0.24
Weight kg/m	0.36



PLASTIC CHAIN AND SPROCKET

Straight Running Chain & Sprocket

60P Plastic straight running chain

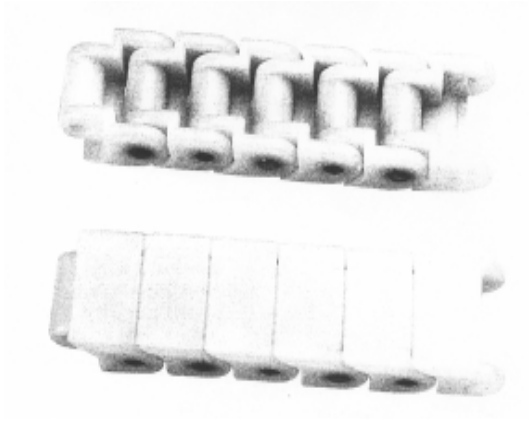

Chain Part NO.	Widths	
	Inch	mm
POM W (Acetal white)		
60P	1.18	30.00

Dimensions

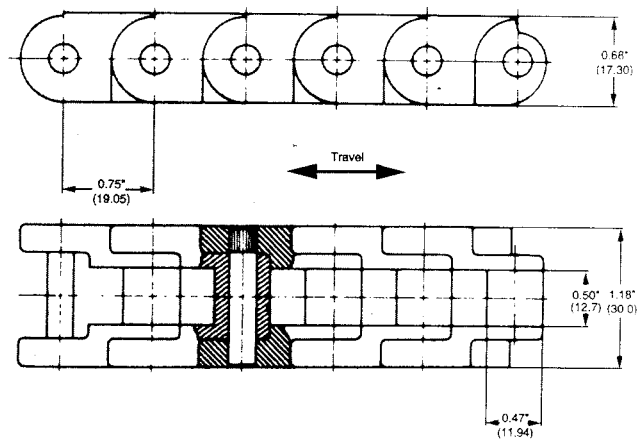
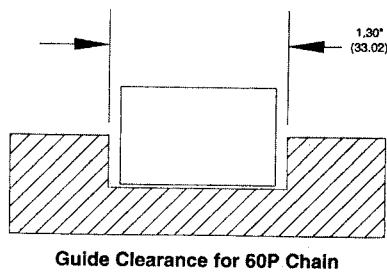

Technical Specifications

Tensile strengths @ 68°F (20°C)
 Acetal: W 200 lbf (890 N)
Load capacity for use in RAM standard selection calculations

Backflex radius
 8" (203mm)

Standard packing
 Approximately 10 feet (3 m)

- Available in Acetal (white).
- Standard pin material - 18/8 CrNi stainless steel.
- Can run at speeds up to 200 ft/min (1.0 m/sec).
- Driven by standard #60 roller chain sprockets.

Chain weights	
60P	
Weight lbs/ft	0.48
Weight Kg/m	0.71



PLASTIC CHAIN AND SPROCKET

Straight Running Chain & Sprocket

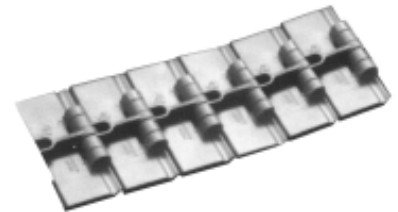
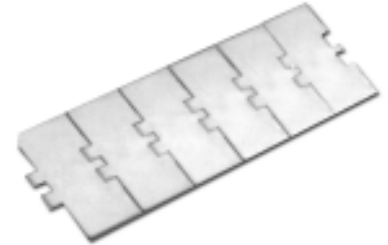
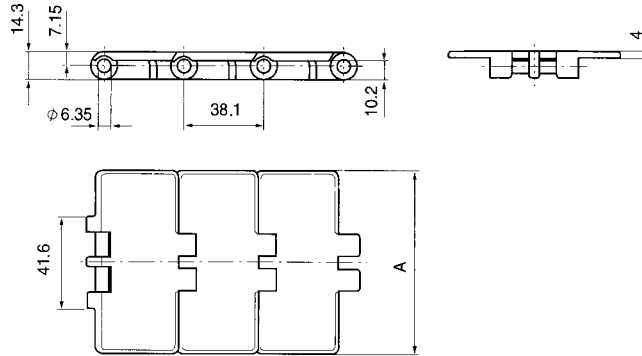

SINGE HINGE CHAINS

chain type	Plate Width (A)		Plate thickness	Working load(max.)	Backflex radius(min.)	Weight
	mm	inch				
820-250	63.5	2.50	4.0	1230	50	0.69
820-325	82.5	3.25	4.0	1230	50	0.82
820-350	88.9	3.50	4.0	1230	50	0.87
820-400	101.6	4.00	4.0	1230	50	0.95
820-450	114.3	4.50	4.0	1230	50	1.00
820-600	152.4	6.00	4.0	1230	50	1.20
820-750	190.5	7.50	4.0	1230	50	1.44

Available on "D" "LF" type and different color

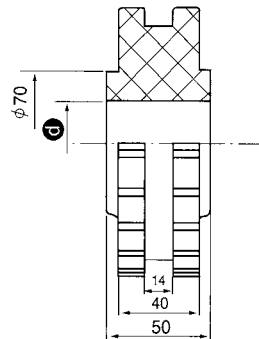

SPROCKET

Nr. of teeth	Pitch diameter(mm)	Outside diameter(mm)	Bore(mm) ①
15	93.7	92.2	20,25,30
17	105.5	104.7	20,25,30
19	117.0	117	25,30,35,40
21	128.9	129	25,30,35,40
25	152.8	153	25,30,35,40

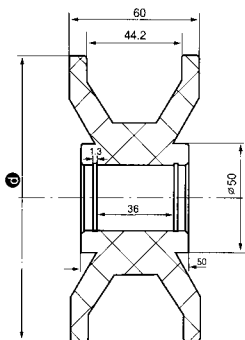

WHEEL

Nr. of teeth	Outside diameter(mm) ①	Hub width(mm)	Bore(mm)
15	93	50	20,25,30
17	105	50	20,25,30
19	107	50	20,25,30
21	131	50	25,30,35,40
25	155	50	25,30,35,40





PLASTIC CHAIN AND SPROCKET

Straight Running Chain & Sprocket

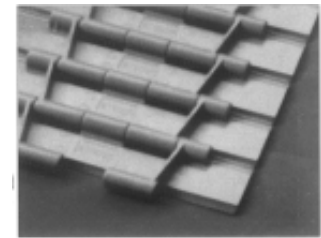
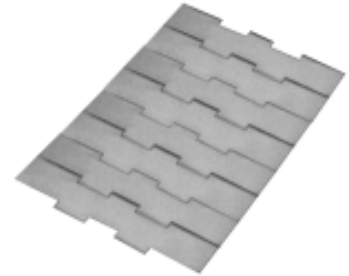
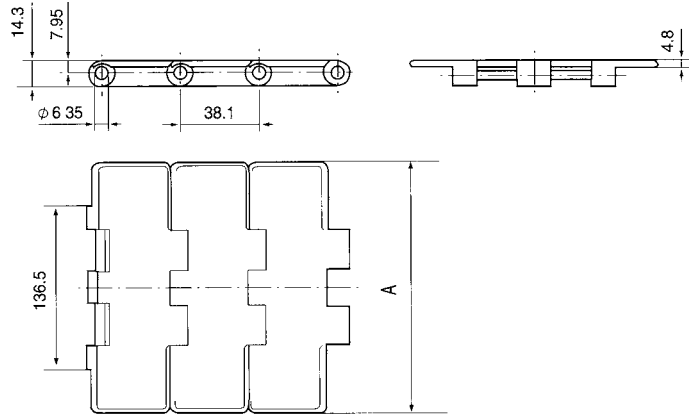

DOUBLE HINGE CHAINS

chain type	Plate Width (A)		Plate thickness	Working load(max.)	Backflex radius(min.)	Weight
	mm	inch				
821-750	190.5	7.5	4.8	2680	50	2.48
821-1000	254.0	10	4.8	2680	30	2.82
821-1200	304.8	12	4.8	2680	50	3.12



SPROCKET

Nr. of teeth	Pitch diameter(mm)	Outside diameter(mm)	Hub width(mm)	Bore(mm)
19	117.0	117	90	25,30,35,40
21	128.9	129	90	25,30,35,40
25	152.8	153	90	25,30,35,40

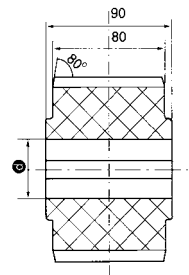

WHEEL

Nr. of teeth	Outside diameter(mm)	Hub width(mm)	Bore(mm)
21	131	146	25,30,35,40
25	155	146	25,30,35,40

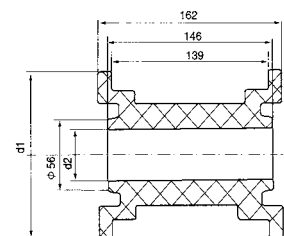



PLASTIC CHAIN AND SPROCKET

Sideflex Chain & Sprocket

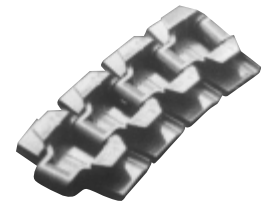
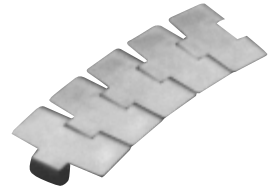
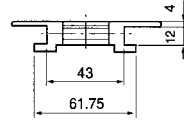
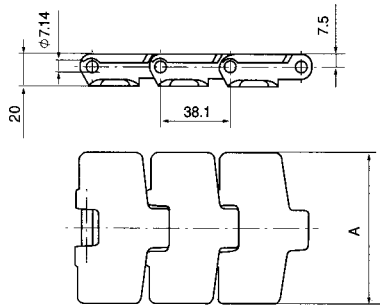

STANDARD RADIUS HINGE CHAINS

chain type	Plate Width (A)		Plate thickness	Working load(max.)	Sideflex radius(min)	Backflex radius(min.)	Weight
	mm	inch					
880T325	82.6	3.25	4.0	2100	500	50	1.15
880T450	114.3	4.50	4.0	2100	610	50	1.30

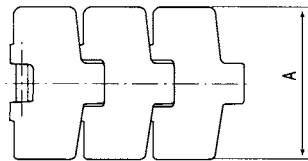
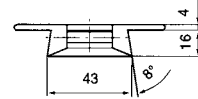
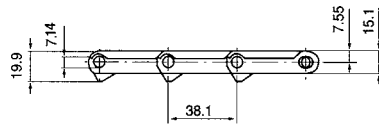
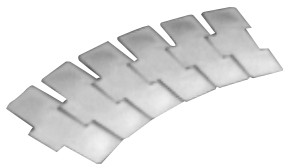

STANDARD RADIUS HINGE CHAINS

chain type	Plate Width (A)		Plate thickness	Working load(max.)	Sideflex radius(min)	Backflex radius(min.)	Weight
	mm	inch					
880-325	82.6	3.25	4.0	2100	500	50	0.89
880-450	114.3	4.50	4.0	2100	610	50	1.04

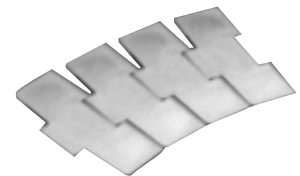
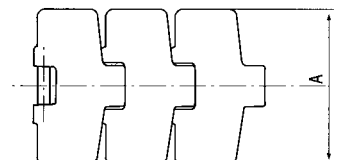
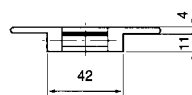
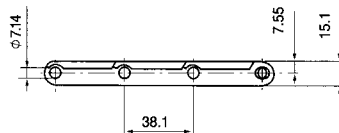
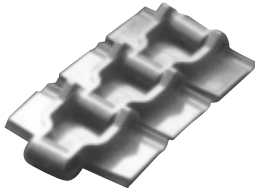

MAGNETIC CHAINS

chain type	Plate Width (A)		Plate thickness	Working load(max.)	Sideflex radius(min)	Backflex radius(min.)	Weight
	mm	inch					
RHM325XL	82.6	3.25	4.0	2100	500	50	1.03
RHM450XL	114.3	4.50	4.0	2100	610	50	1.16

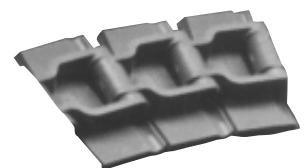



PLASTIC CHAIN AND SPROCKET

Sideflex Chain & Sprocket

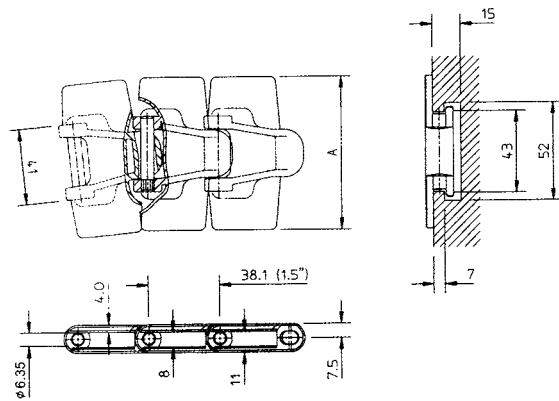

SMALL RADIUS HINGE CHAINS

chain type	Plate Width (A)		Plate thickness	Working load(max.)	Sideflex radius(min)	Backflex radius(min.)	Weight
	mm	inch					
SRH325XL	82.6	3.25	4.0	1780	200	50	0.87

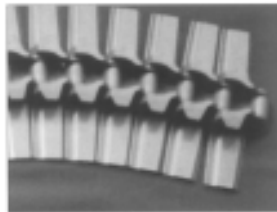
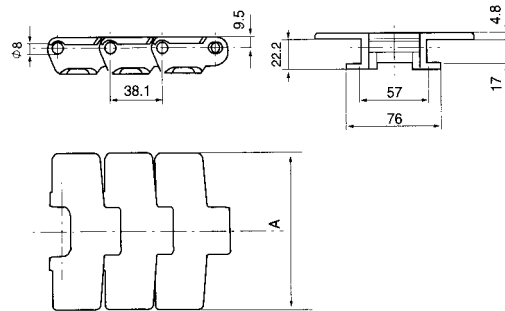
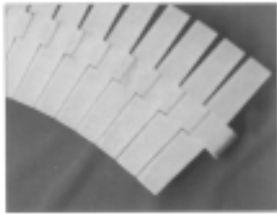

STANDARD RADIUS HINGE CHAINS

chain type	Plate Width (A)		Plate thickness	Working load(max.)	Sideflex radius(min)	Backflex radius(min.)	Weight
	mm	inch					
882T750	190.5	7.5	4.8	3830	610	50	2.38
882T1000	254.0	10	4.8	3830	610	58	2.69
882T1200	304.8	12	4.8	3830	610	50	2.94

SPROCKET FOR SIDEFLET CHAIN

No. of teeth	Pitch diameter(mm)	Outside diameter(mm)	Bore(mm) ⓐ
10	123.3	122	25,30,35
11	135.2	134	25,30,35
12	147.2	146	25,30,35

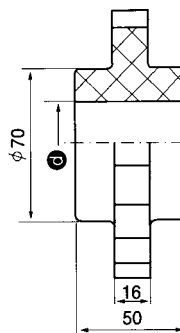



PLASTIC CHAIN AND SPROCKET

Plastic Snap-on Chain

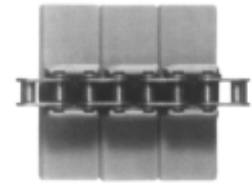
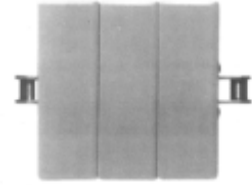
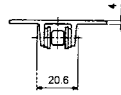
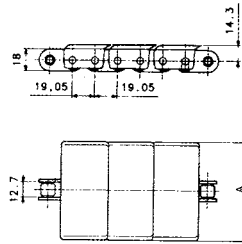

STRAIGHT RUNNING TWO-PIECE CHAINS WITH THERMOPLASTIC FLIGHTS

chain type	Material		Standard with(A)		Weight kg/m
	Roller chain	Top plate	inch	mm	
963-325	Stainless steel	Acetal	3.25	82.6	2.02
963-600	Stainless steel	Acetal	6	152.4	2.45
963-750	Stainless steel	Acetal	7.5	190.5	2.60

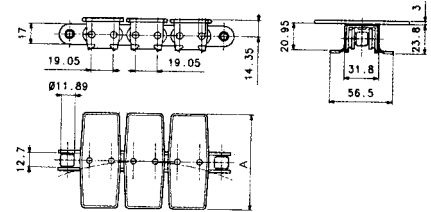

SIDEFLEXING TWO-PIECE CHAINS WITH THERMOPLASTIC FLIGHTS

chain type	Material		Standard with(A)		Weight kg/m
	Roller chain	Top plate	inch	mm	
1873T-325	Stainless steel	Acetal	3.25	82.6	2.10
1873T-600	Stainless steel	Acetal	6.00	152.4	2.41
1873T-750	Stainless steel	Acetal	7.50	190.5	2.56
1873T-1000	Stainless steel	Acetal	10.0	254.0	2.78
1873T-1200	Stainless steel	Acetal	12.0	304.8	3.00

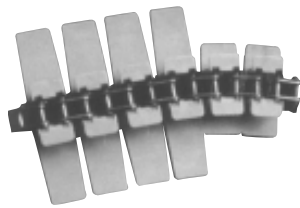

SPROCKETS FOR ABOVE CHAIN

No. of teeth	Pitch diameter(mm)	Outside diameter(mm)	Hub diameter(mm)	Bore(mm)
15	91.63	99.8	70	15
17	103.67	111.5	80	15
19	115.75	124.2	80	15
21	127.82	136.0	90	20
23	139.90	149.0	90	20
25	152.00	160.0	90	20
27	164.09	172.3	95	20
29	175.19	184.1	95	20
31	188.31	196.3	100	25

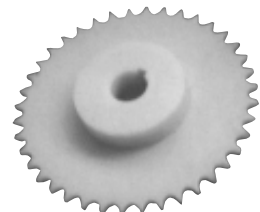
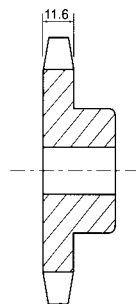



PLASTIC CHAIN AND SPROCKET

Straight Running Anti-static chain

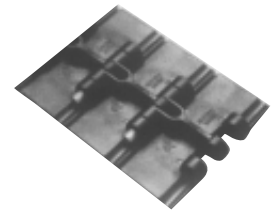
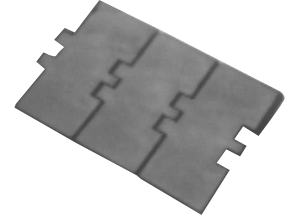
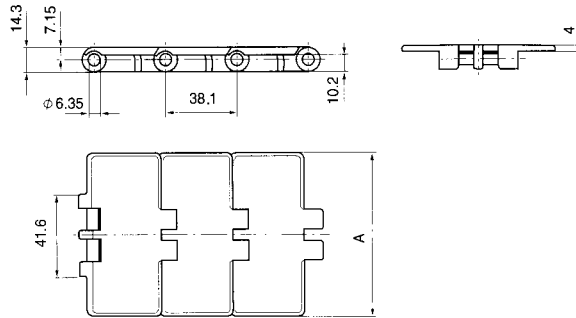

STRAIGHT RUNNING ANTI-STATIC CHAINS (BLACK)

chain type	Plate Width (A)		Plate thickness	Working load(max.) N	Backflex radius(min.) mm	Weight kg/m
	mm	inch				
820-250	63.5	2.50	4.0	1100	50	0.67
820-325	82.5	3.25	4.0	1100	50	0.80
820-350	88.9	3.50	4.0	1100	50	0.85
820-400	101.6	4.00	4.0	1100	50	0.92
820-450	114.3	4.50	4.0	1100	50	0.98
820-600	152.4	6.00	4.0	1100	50	1.15
820-750	190.5	7.50	4.0	1100	50	1.40



SPROCKET

No. of teeth	Pitch diameter(mm)	Outside diameter(mm)	Bore(mm)
15	93.7	92.2	20,25,30
17	105.5	104.7	20,25,30
19	117.0	117	25,30,35,40
21	128.9	129	25,30,35,40
25	152.8	153	25,30,35,40

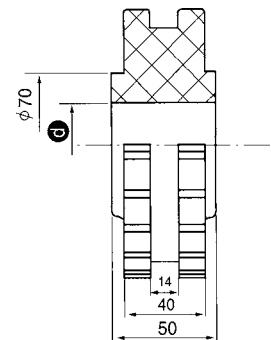

WHEEL

No. of teeth	Outside diameter(mm)	Hub width(mm)	Bore(mm)
15	93	50	20,25,30
17	105	50	20,25,30
19	107	50	20,25,30
21	131	50	25,30,35,40
25	155	50	25,30,35,40

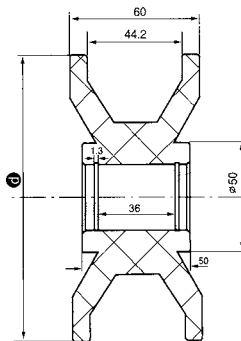



PLASTIC CHAIN AND SPROCKET

Sideflexing Anti-static Chain

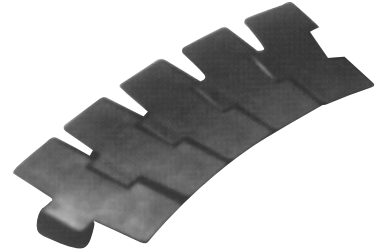
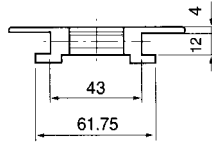
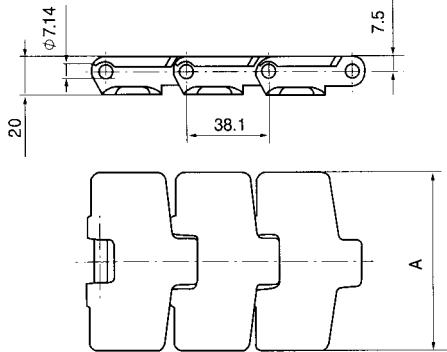

SIDEFLEXING ANTI-STATIC CHAINS (BLACK)

chain type	Plate Width (A)		Plate thickness	Working load(max.)	Backflex radius(min.)	Weight
	mm	inch	mm	N	mm	kg/m
880T325	82.6	3.25	4.0	2000	50	0.89
880T450	114.3	4.50	4.0	2000	50	1.04

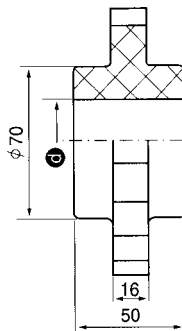
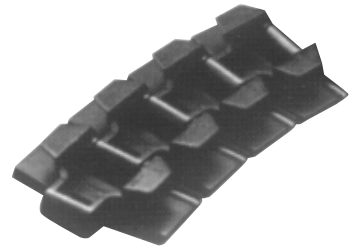

SPOCKET FOR SIDEFLEX CHAIN

Nr. of teeth	Pitch diameter(mm)	Outside diameter(mm)	Bore(mm) ⓐ
10	123.3	122	25,30,35
11	135.2	134	25,30,35
12	147.2	146	25,30,35



PLASTIC CHAIN AND SPROCKET

Belt Chain & Sprocket

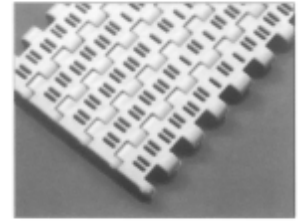
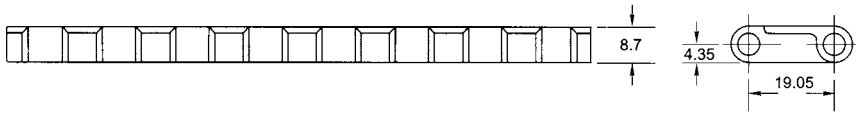

part No.s936

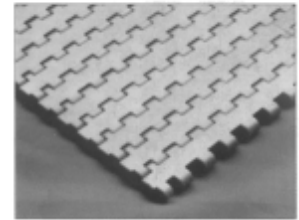
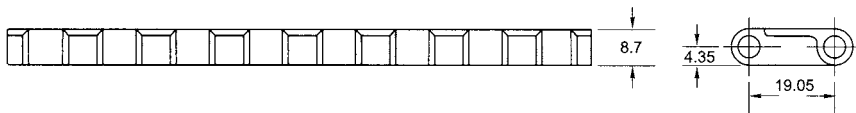

part No.5935

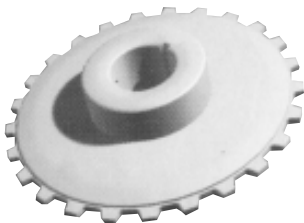
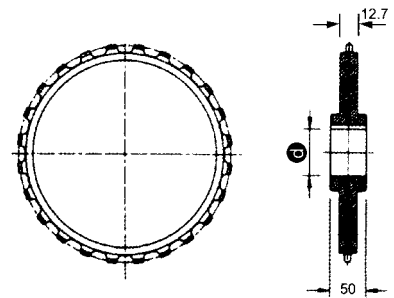

SPROCKET FOR BELT CHAIN

No. of teeth	Outside diameter(mm)	Pitch dia(mm)	Bore	
			Round(mm)	Square(mm)
10	63	62	25	
24	149	147	25	40
			30	50
			35	65
			40	
			50	
25	156	153		40
				50



PLASTIC CHAIN AND SPROCKET

Belt Chain & Sprocket

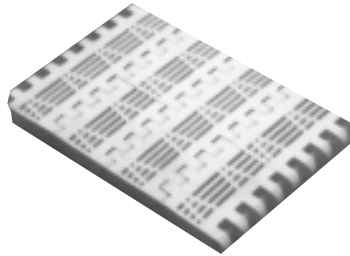

OPB Series

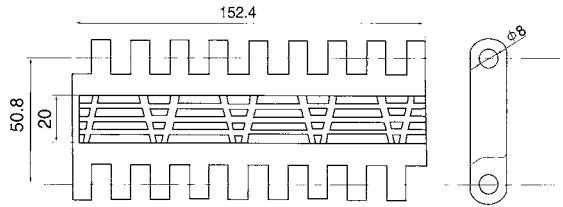

BELT CHAIN

chain type	Plate Width (A)		Working load(max.) N	Backflex radius(min.) mm	Weight kg/m
	mm	inch			
WP-1	152.4	6	2100	50	1.44

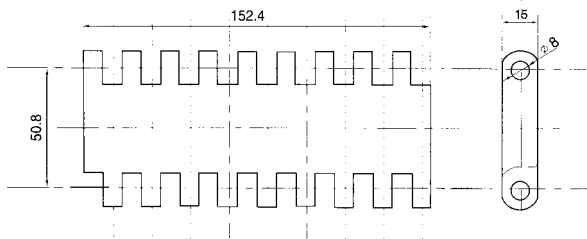

OPBC Series

BELT CHAIN

chain type	Plate Width (A)		Working load(max.) N	Backflex radius(min.) mm	Weight kg/m
	mm	inch			
WP-2	152.4	6	2100	50	1.54

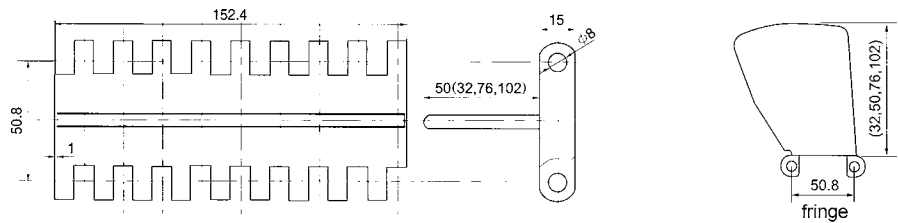
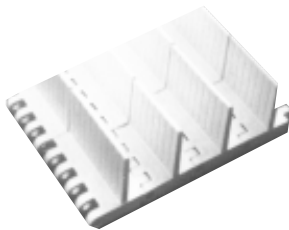

BELT CHAIN

chain type	Plate Width (A)		Working load(max.) N	Backflex radius(min.) mm	Weight kg/m
	mm	inch			
WP-3	152.4	6	2100	50	2.04

SPROCKET

Nr. of teeth	Outside diameter(mm)	Hub diameter(mm)	Hub width(mm)	Bore	
				Bore(mm)	Square(mm)
10	160	125	42.6	25,30,40,50	30,38.3,40,50
12	196	157	42.6	25,30,40,50	30,38.3,40,50
14	228	189	42.6	25,30,40,50	30,38.3,40,50

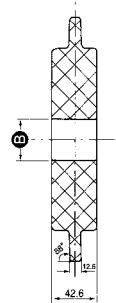



PLASTIC CHAIN AND SPROCKET

Belt Chain & Sprocket



SLK-127(N-SMG)
Light AEP:Series

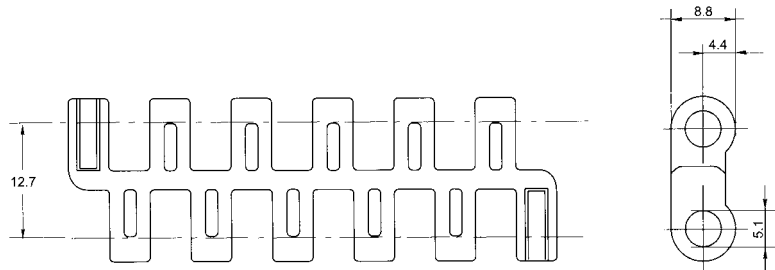

STADARD BELT WIDTH

inch	3.0	6.0	9.0	12.0	15.0	18.0	21.0	24.0	27.0	30.0	33.0	36.0	39.0	42.0	45.0	48.0	51.0	54.0	57.0	60.0
mm	76	152	228	305	381	457	533	607	683	762	838	914	990	1066.8	1143	1219.2	1295.4	1371.6	1447.8	1524
inch	63	66	69	72	75	78	81	84	87	90	93	96	99	102	105	108	111	114	117	120
mm	1600.2	1676.4	1752.6	1828.8	1905	1981.2	2057.4	2133.6	2209.8	2286	2362.2	2438.4	2514.6	2590.8	2667	2743.2	2819.4	2895.6	2971.8	3048

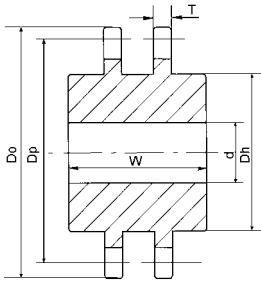

DIMENSIONS OF SPROCKET

No of teeth	Bore : d				Dp		Do		Dh		W		T	
	min		max		Pitch dia		Outside dia		Hub dia.		Hub Width		Teeth width	
	mm	inch	mm	inch	mm	inch	mm	inch	mm	inch	mm	inch	mm	inch
10	10.00	0.39	18	0.71	41.1	1.62	40.1	1.58	28.0	1.10	20.0	0.79	2.0	0.08
19	19.05	0.75	40.0	1.57	77.2	3.04	76.2	3.00	64.0	2.52	20.0	0.79	2.0	0.08
28	19.05	0.75	60.0	2.36	113.4	4.46	112.4	4.43	75.0	2.95	20.0	0.79	2.0	0.08
38	19.05	0.75	60.0	2.36	153.8	6.06	152.8	6.02	75.0	2.95	20.0	0.79	2.0	0.08

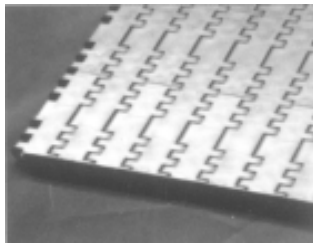

Part No.7705

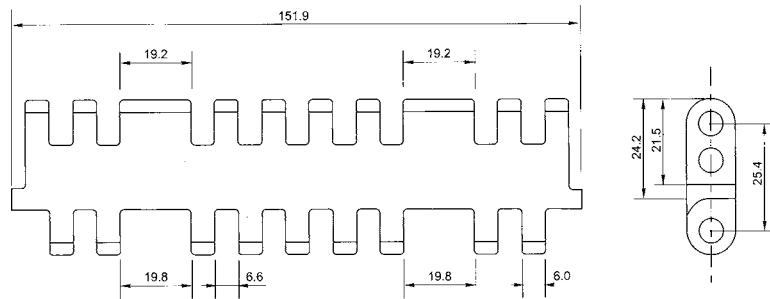
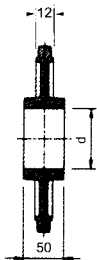

Plate Width (A)		Weight
mm	inch	kg/m
76.2	3	1.0
152.4	6	1.9



SPROCKET

No. of teeth	Outside diameter(mm)	Pitch dia(mm)	Bore(mm) : d
16	130.60	130.20	25, 30, 35, 40
18	146.90	146.28	
21	170.70	170.43	





PLASTIC CHAIN AND SPROCKET

Belt Chain & Sprocket

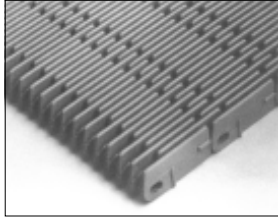

4809

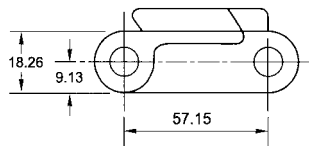
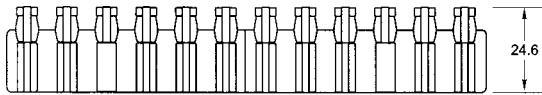
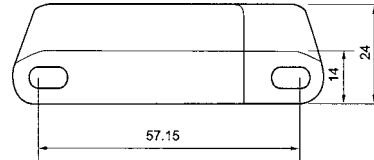

5997

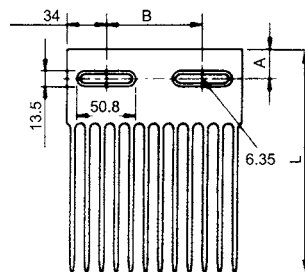
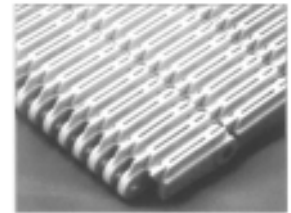

COMBS

L		A		B	
in.	mm	in.	mm	in.	mm
5.75	146.1	1.00	25.4	4.00	101.6
7.50	190.5	1.00	25.4	3.25	82.6

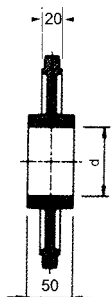

SPROCKET

No. of teeth	Outside dia		Pitch dia		Bore : d	
	inch	mm	inch	mm	Round	Square
					mm	mm
7	4.940	126	5.186	132	30 , 40 , 50 , 60 , 90	
9	6.460	164	6.578	167		
12	8.700	221	8.693	221		
14	10.100	257	10.111	257		
17	12.361	314	12.245	311		





PLASTIC CHAIN AND SPROCKET

Belt Chain & Sprocket

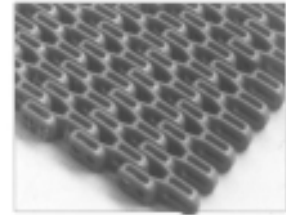
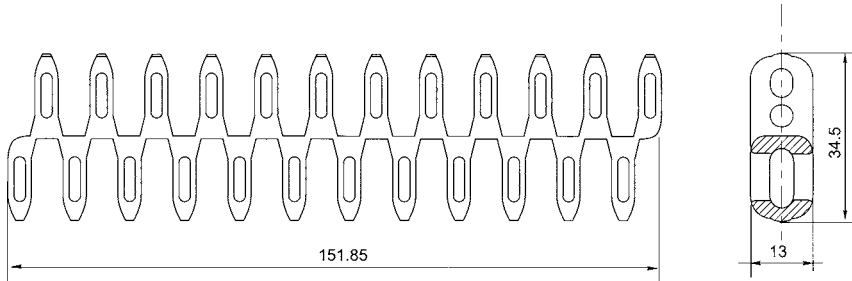

FLEX-SNB
Light AEP Series

STANDARD BELT WIDTH (SUDEFLEX RADIUS=WIDTH x 2.3)

inch	3.0	6.0	9.0	12.0	15.0	18.0	21.0	24.0	27.0	30.0	33.0	36.0	39.0
mm	76	152	228	305	381	457	533	607	683	762	838	914	990

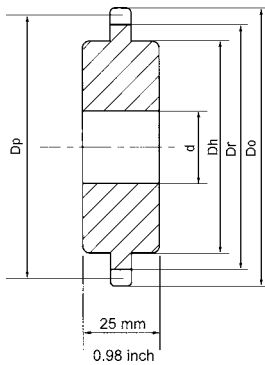

DIMENSION OF SPROCKET

No of teeth	Bore: d				Dp		Do		Dr		Dh	
	min		max		Pitch Dia		Outside Dia		Root Dia.		Hub Dia	
	mm	inch	mm	inch	mm	inch	mm	inch	mm	inch	mm	inch
9	19.05	0.75	40.0	1.57	74.3	2.93	73.8	2.91	56.8	2.24	56.8	2.24
10	19.05	0.75	40.0	1.57	82.2	3.24	82.2	3.24	65.2	2.57	65.2	2.57
12	19.05	0.75	40.0	1.57	98.1	3.86	98.8	3.89	81.8	3.22	70.0	2.76
15	19.05	0.75	63.5	2.50	122.2	4.81	123.5	4.86	106.5	4.19	70.0	2.76
18	19.05	0.75	60.0	2.36	146.3	5.76	144.5	5.69	127.5	5.02	70.0	2.76
19	19.05	0.75	60.0	2.36	154.3	6.08	156.2	6.15	139.2	5.48	70.0	2.76
28	19.05	0.75	60.0	2.36	226.8	8.93	229.4	9.03	212.4	8.36	70.0	2.76

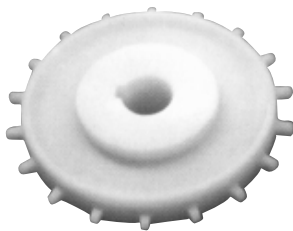



PLASTIC CHAIN AND SPROCKET

Pivot Radius Chain With Tabs

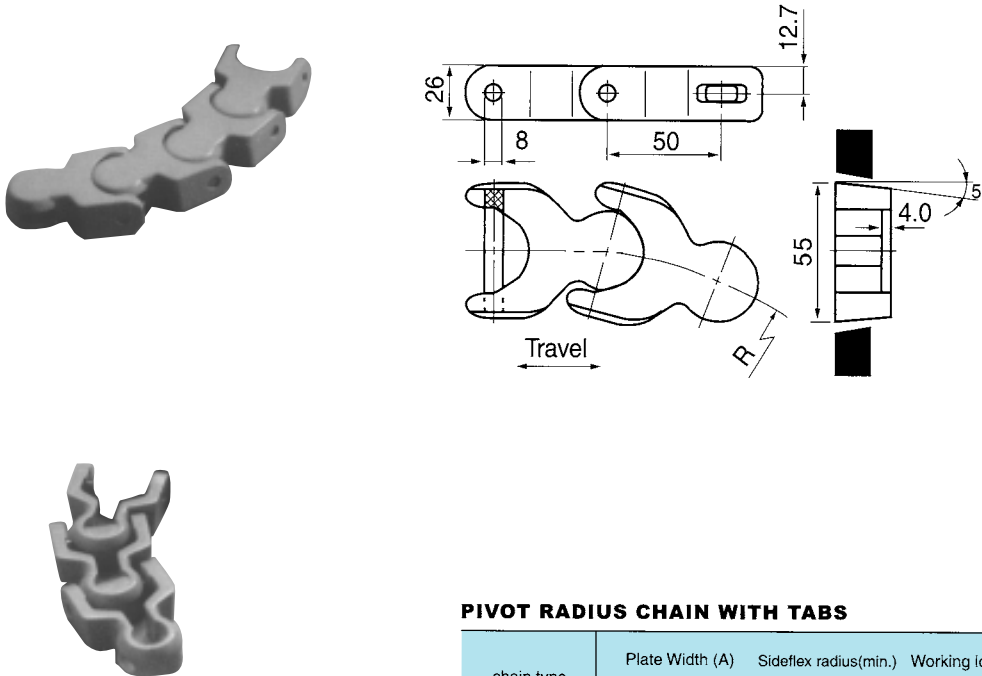

PIVOT RADIUS CHAIN WITH TABS

chain type	Plate Width (A)		Sideflex radius(min.)	Working load(max.)	Backflex radius(min.)	Weight
	mm	inch				
PR200	55.0	2.17	150	3330	50	1.55



SPROCKET FOR ABOVE CHAIN

No. of teeth	Outside diameter(mm)	Pitch dia(mm)	Bore(mm)
10	165	161.8	25, 30, 35, 40
12	196	193.2	
14	227	224.7	

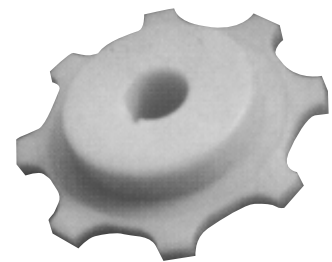



PLASTIC CHAIN AND SPROCKET

Wear Strips

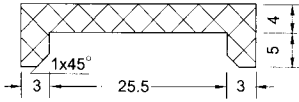

W56 50M/roll UHMW-PE

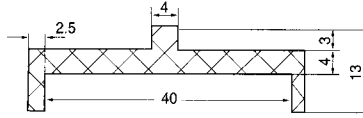

W19 50M/roll UHMW-PE

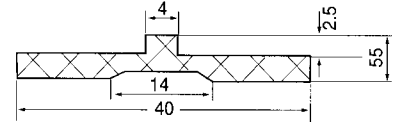

Part 242
W20 50M/roll UHMW-PE

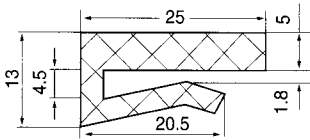

W29 50M/roll UHMW-PE

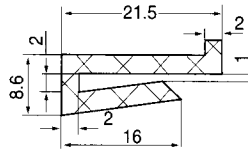

W47 50M/roll UHMW-PE

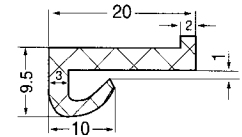

W48 50M/roll HDPE

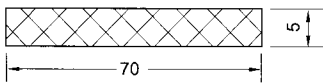

W54 50M/roll HDPE

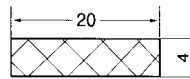

W51 50M/roll HDPE

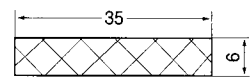

W52 50M/roll HDPE

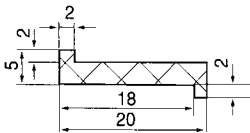

Part 241 (W27 50M/roll UHMW-PE)

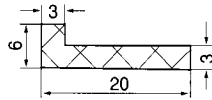

Part 243 (W55 50M/roll UHMW-PE)

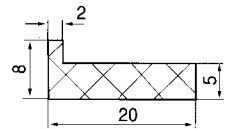

W21 50M/roll UHMW-PE

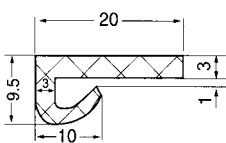

Part 261 (W49 50M/roll UHMW-PE)

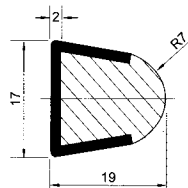

Part 219 (W58 2.7M/roll UHMW-PE)

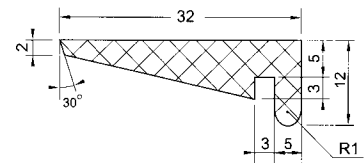

W53 50M/roll HDPE

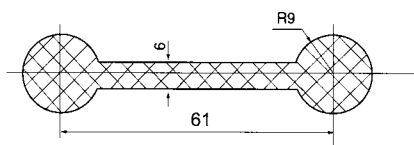

G3 HDPE

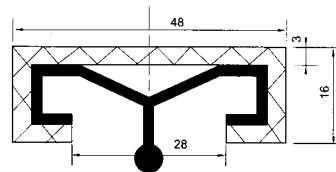

G4 HDPE

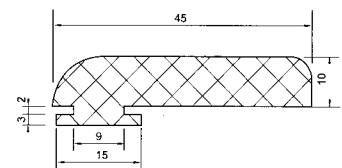

W59 50M/roll HDPE



PLASTIC CHAIN AND SPROCKET

Accessories



P101

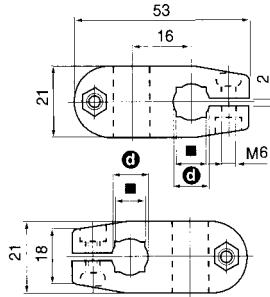

Rod ∅	Square rod	∅ 12	∅ 10
Ⓧ mm	■ mm	∅ 14	∅ 12



P102

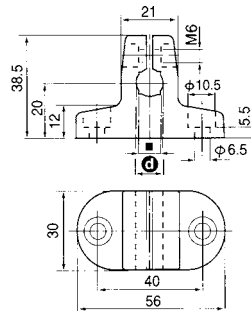

Rod ∅	Square rod	∅ 12	∅ 10
Ⓧ mm	■ mm	∅ 14	∅ 12



P201

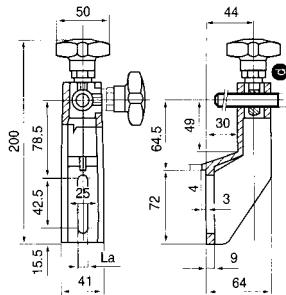

Bore dia. Ⓧ mm
∅ 12 ~ ∅ 16
Tol. mm
± 0.2



P202

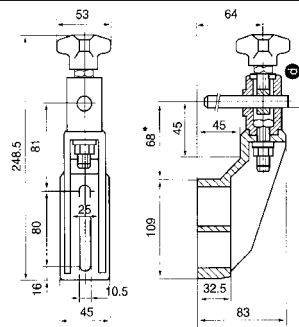

Bore: dia. Ⓧ mm
∅ 12 ~ ∅ 16
Tol. mm
± 0.2



P301

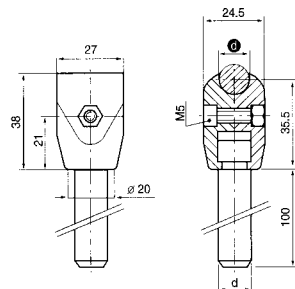

Bore: dia. Ⓧ mm
∅ 12 ~ ∅ 16
Tol. mm
± 0.2



PLASTIC CHAIN AND SPROCKET

Accessories

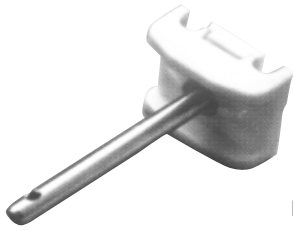

P302

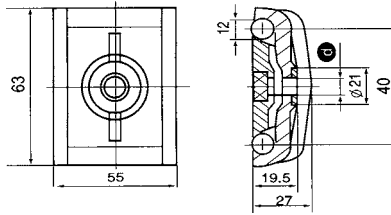

Bore dia. ϕ mm
 $\phi 12 \sim \phi 16$
 Tol. mm
 ± 0.2



P303

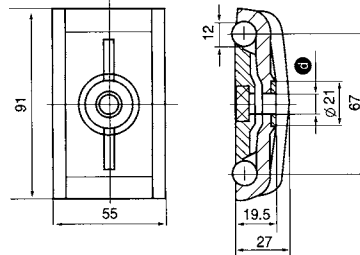

Bore dia. ϕ mm
 $\phi 12 \sim \phi 16$
 Tol. mm
 ± 0.2



P304

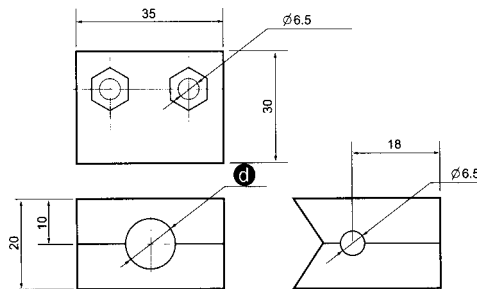

Bore dia. ϕ mm
 $\phi 12$
 Tol. mm
 ± 0.2



P305

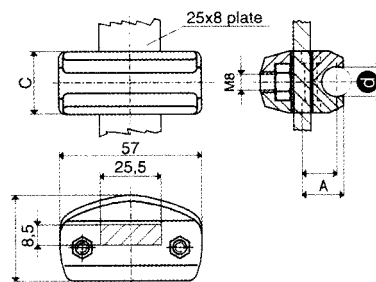

Bore dia. ϕ mm
 $\phi 12$
 Tol. mm
 ± 0.2



P306

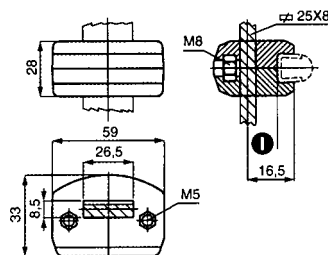

ϕ mm
 8
 Tol. mm
 ± 0.2



PLASTIC CHAIN AND SPROCKET

Accessories

Bore dia. ϕ mm
 $\phi 40 \sim \phi 63$
 Tol. mm
 ± 0.2

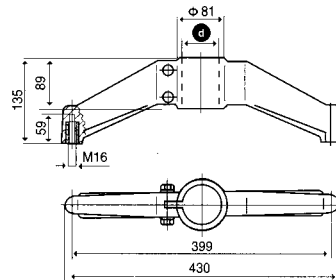

P401



Bore dia. ϕ mm
 $\phi 40 \sim \phi 63$
 Tol. mm
 ± 0.2

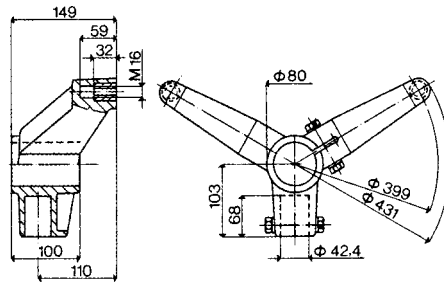

P402



Bore dia. ϕ mm
 $\phi 40 \sim \phi 63$
 Tol. mm
 ± 0.2

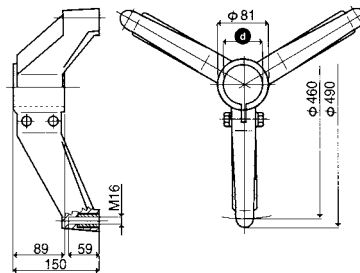

P403



Bore dia. ϕ mm
 $\phi 48.3 \sim \phi 60.3$
 Tol. mm
 ± 0.2

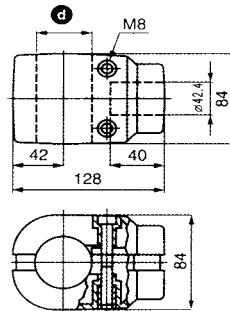

P501



Bore dia. ϕ mm
 $\phi 40 \sim \phi 63$
 Tol. mm
 ± 0.2

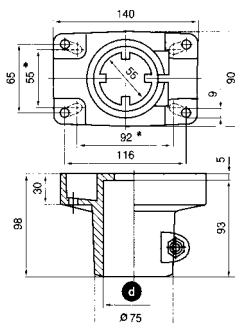

P502





PLASTIC CHAIN AND SPROCKET

Accessories



P801

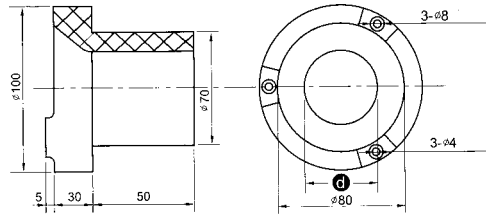

Bore dia. d mm
 $\phi 40 \sim \phi 60$
 Tol. mm
 ± 0.2



P603

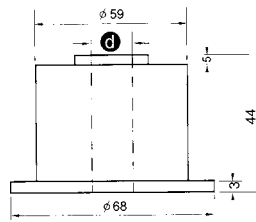

Bore dia. d mm
 $\phi 20$
 Tol. mm
 ± 0.2



P601

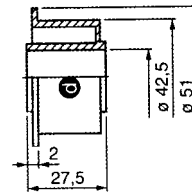

Bore dia. d mm
 $\phi 20.5$
 Tol. mm
 ± 0.2



P602

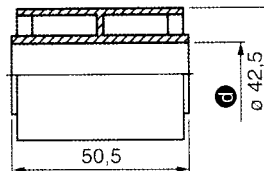

Bore dia. d mm
 $\phi 20$
 Tol. mm
 ± 0.2



P701

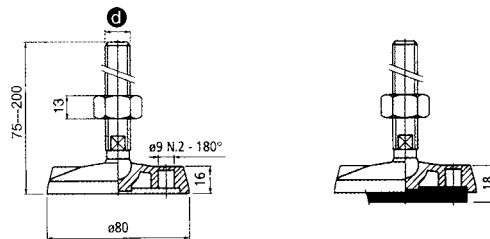

Bore dia. d mm
 M12 ~ M16
 Tol. mm
 ± 0.2



P702

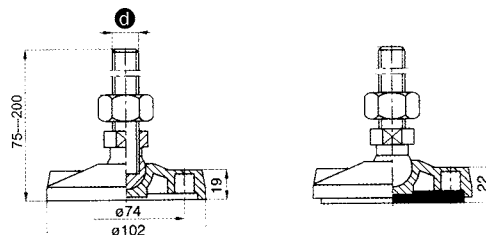

Bore dia. d mm
 M12 ~ M16
 Tol. mm
 ± 0.2



PLASTIC CHAIN AND SPROCKET

Track Curve

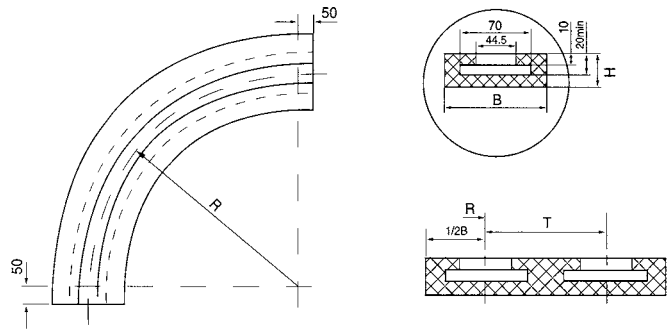

CURVES

For chain type	Radius	Pitch	Basic width	thickness
	R(mm)	T(mm)	B(mm)	H
880T325	500			
880-325	610	89	100	32
RHM325XL	840			
	1000			
880T450	500			
880-450	610	120	129	32
RHM450XL	840			
	1000			
882T750	610	195	200	32

HINGE A

Fixing screw	Df mm	D mm	h mm
M6	6.5	10.5	6

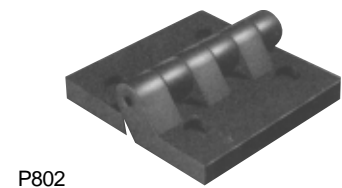
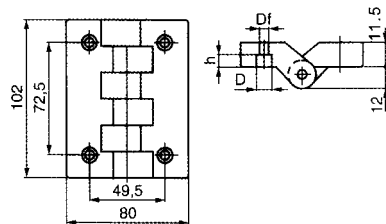

P802

HINGE B

Fixing screw	A mm	B mm	C mm
M6	6.5	10.5	6

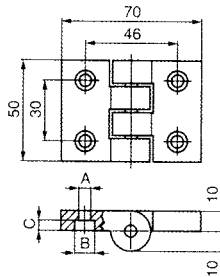

P802

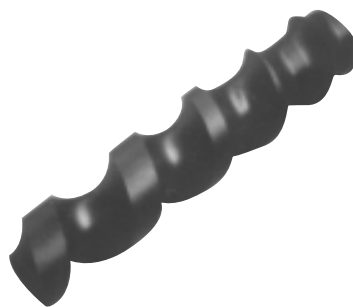

Screw stem
(made to order)